

LRS-3.0 MINI SEPARATOR VESSEL

The EnPro LRS-3.0 Mini Separator vessel is designed to assist in the removal of liquids from high water content in well head gas.

HOW DOES IT WORK?

Pipeline gas can be extracted from the flowing stream of the pipeline using an EnPro PFP pitot probe. The gas / water mix is then separated in the main housing of the LRS-3.0 vessel.

The dropout water is returned to the pipeline and the separated gas in the upper section of the vessel can then be regulated using an EnPro PFIR insertion regulator for piping to instruments/pumps.

The LRS-3.0 vessel has an internal baffle that prevents liquids being splashed towards the regulator and also allows liquids formed at the regulator tip to be returned.

PRODUCTS TO USE IN CONJUNCTION WITH THE ENPRO LRS-3.0

- The EnPro PFP pitot probe can be used to extract the gas. It creates a pressure differential which assists in returning liquids to the pipeline.
- The EnPro PFIR can be used for regulating and piping the gas elsewhere. It has a shielded tip to prevent liquids entering the regulator.
- The EnPro FC1.6 Filter Dryer can be used to filter and remove any excess moisture.

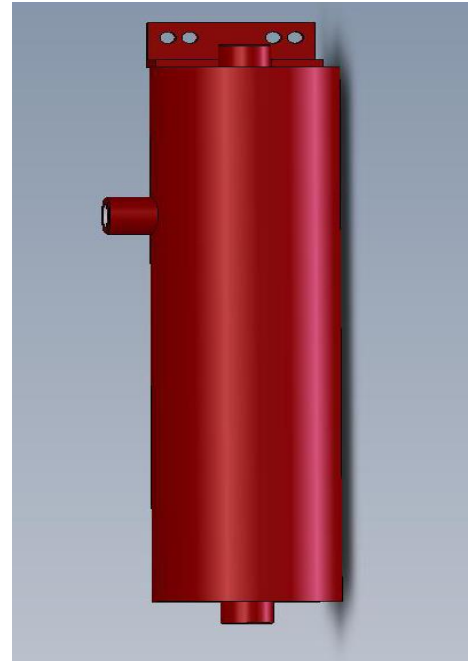

ABOUT US

Since 1990, Haldatec has been providing products and services to the Oil, Gas and related industries in Australia, Pakistan, Singapore, Papua New Guinea, India and New Zealand.

ENPRO

Our house product label, EnPro, has been developed to complement our core business and has been driven by customer needs. Our comprehensive range includes innovative designs, adaptations and applications introduced to solve problems for our customers.

STANDARDS

To ensure we provide the best possible support for our customers and suppliers, we have certification to ISO9001:2015.